



**KRATER** Скопје

Production of  
"THERMO - TECHNICAL INSTALLATIONS"  
TD.KRATER – Skopje  
n.m ILINDEN st.34 No. 1  
1041 Skopje  
Republic of Macedonia

Tel: +389 2 2552 922  
Fax: +389 2 2552 966  
e-mail: [info@krater.mk](mailto:info@krater.mk)  
[www.krater.mk](http://www.krater.mk)

# ACCESSORIES CATALOGUE



# Rectangular duct profile PQ



## Description

The PQ profile is made of galvanized steel sheet and is used for connecting rectangular ventilation ducts. It is mounted directly on the end of a duct and a fitting.

Depending on dimensions of a duct and air pressure inside a duct three dimensions of the profile may be used. The aluminium and acid-resistant steel profiles are always produced with a sealing specially designed for ventilation ducts.

A range of working temperatures for a sealing is  $-30^{\circ}\text{C}$  up to  $+100^{\circ}\text{C}$ . Maximal momentary temperature to which the sealing may be subjected is  $+200^{\circ}\text{C}$ . The sealing material is resistant to ageing, has a good adherence to a base, good mechanical stability and makes a good anti-corrosive protection.

**Packing:** 5 m long sections packed in 500 meters bundles, and 3 m long sections packed in 300 meters.

### Example identification

Product code: **PQ-C-20-ECO-SIL**

material  
dimension  
version  
sealing

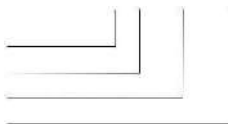

pressure [Pa]	dimension of „a” or „b”					2501 [mm]
	< 500 [mm]	500-1000 [mm]	1001-1600 [mm]	1601-2500 [mm]		
200	PQ 20	PQ 20	PQ 30	PQ 30	PQ 40	
400	PQ 20	PQ 20	PQ 30	PQ 30	PQ 40	
600	PQ 20	PQ 20	PQ 30	PQ 30	PQ 40	
800	PQ 20	PQ 20	PQ 30	PQ 30	PQ 40	
1000	PQ 20	PQ 20	PQ 30	PQ 30	PQ 40	
1200	PQ 20	PQ 30	PQ 30	PQ 40	PQ 40	
1500	PQ 20	PQ 30	PQ 30	PQ 40	PQ 40	

## Dimensions

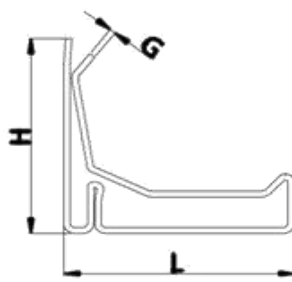

Profil PQ

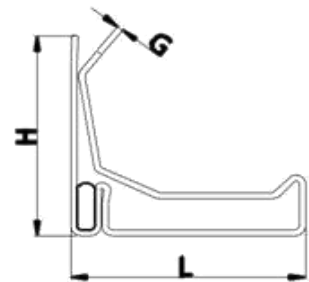

Profil PQ-SIL z uszczelnieniem

type	height H [mm]	widht L [mm]	thickness G [mm]
PQ-C-20	25	20	0,7
PQ-C-30	25	30	0,8
PQ-C-40	30	40	0,9
PQ-C-20-ECO	25	20	0,6
PQ-C-30-ECO	25	30	0,7
PQ-C-40-ECO	30	40	0,8
PQ-C-20-SIL	25	20	0,7
PQ-C-30-SIL	25	30	0,8
PQ-C-40-SIL	30	40	0,9
PQ-C-20-ECO-SIL	25	20	0,6
PQ-C-30-ECO-SIL	25	30	0,7
PQ-C-40-ECO-SIL	30	40	0,8
PQ-K-20-SIL*	25	20	0,6
PQ-K-30-SIL*	25	30	0,6
PQ-K-40-SIL*	30	40	0,7
PQ-A-20-SIL**	25	20	0,7
PQ-A-30-SIL**	25	30	0,8
PQ-A-40-SIL**	30	40	0,9

\* delivery in 1.4301 brand according to the EN 10088 standard

\*\* delivery in 1050A brand according to the PN-EN 573-3 standard

# Side Corners for Rectangular Ducts

## NQ



### Description

NQ galvanised side corners are used to join PQ20, 30 and 40 channels and thus create an end cover for connecting two rectangular ducts. The side corners can be made of acid-proof material or aluminium.

#### Example identification

Product code: **NQ-20-C**

type \_\_\_\_\_  
material \_\_\_\_\_

### Dimensions

Side Corner NQ-C-20

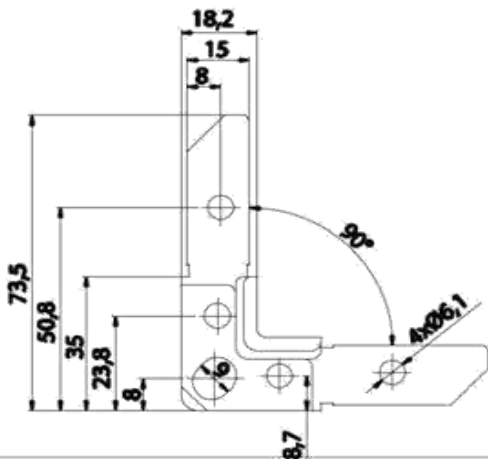

Side Corner NQ-C-20K

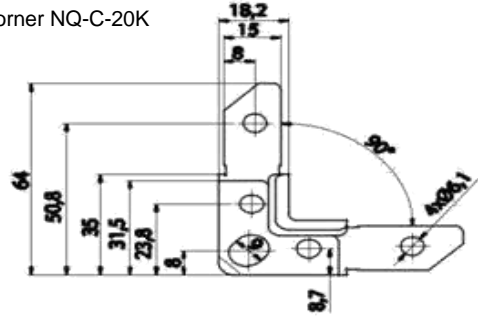

Side Corner NQ-C-20L

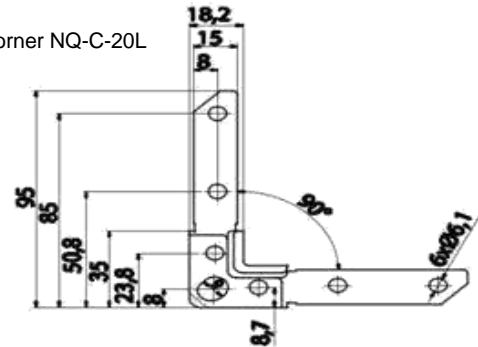

Side Corner NQ-C-30

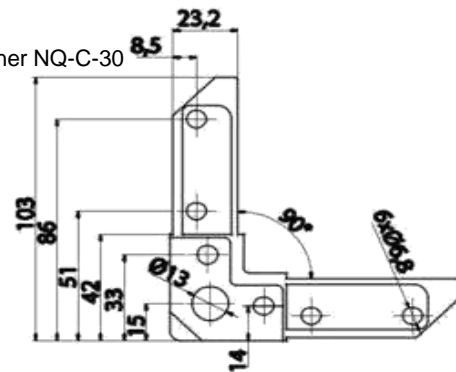

Side Corner NQ-C-40

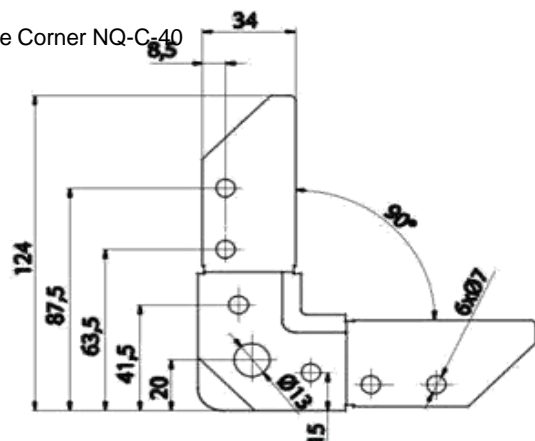



# Threaded Rod PG



## Dimensions

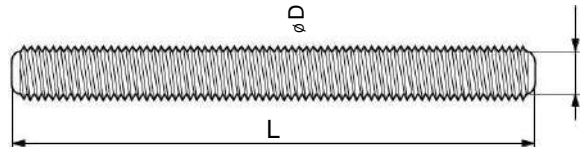

## Description

Threaded rod with galvanised surface. It is suitable for the suspension of ventilation and air-conditioning systems.

### Example identification

Product code: **PG10 -1**

type

type	diameter D [mm]	length L [mm]
PG6-1	M6	1000
PG6-2	M6	2000
PG6-3	M6	3000
PG8-1	M8	1000
PG8-2	M8	2000
PG8-3	M8	3000
PG10-1	M10	1000
PG10-2	M10	2000
PG10-3	M10	3000
PG12-1	M12	1000
PG12-2	M12	2000
PG12-3	M12	3000



# Mounting profile LDB



## Dimensions

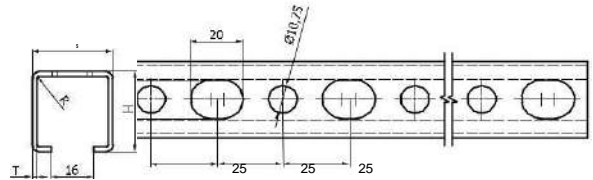

## Description

The LDB mounting profile is designed for suspension of ducts, devices and any kind of ventilation system equipment.

### Example identification

Product code: **LDB - 30 - 30 - 1,50 - 0250**

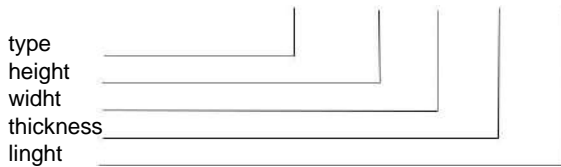

code	S [mm]	H [mm]	T [mm]	L [mb]
LDB-30-20-1,50-0250	30	20	1,50	2,50
LDB-30-20-1,50-0500	30	20	1,50	5,00
LDB-30-20-1,75-0250	30	20	1,75	2,50
LDB-30-20-1,75-0500	30	20	1,75	5,00
LDB-30-30-1,50-0250	30	30	1,50	2,50
LDB-30-30-1,50-0500	30	30	1,50	5,00
LDB-30-30-1,75-0250	30	30	1,75	2,50
LDB-30-30-1,75-0300	30	30	1,75	3,00
LDB-30-30-1,75-0500	30	30	1,75	5,00
LDB-30-45-1,50-0250	30	45	1,50	2,50
LDB-30-45-1,50-0500	30	45	1,50	5,00
LDB-30-45-1,75-0250	30	45	1,75	2,50
LDB-30-45-1,75-0500	30	45	1,75	5,00
LDB-41-21-2,00-0600	41	21	2,00	6,0
LDB-41-41-2,00-0600	41	41	2,00	6,0

\* The standard length is 5m.

# STRUT channel LDBST



## Description

LDB STRUT profiles are delivered in lengths of 2 to 6 m in thicknesses of 1.6, 1.9, 2.0 and 2.5 mm. STRUT profiles are the main component of the mounting components not only ventilation, air conditioning and refrigeration systems, but also for mounting of all kinds of elements requiring suspension. Serrated internal parts are adapted to SNP sliding pads, SNL and SNKL - which together with screws and the profiles form the entire mounting system. We successfully used in the construction of roof brackets and supports, together with ST-ROOF system.

### Attention:

For external solutions should be applied roof structures built with profile LDBSO entirely hot galvanized. It provides over prolonged periods protect against external conditions.

### Example identification

Product code: **LDBST - 41 - 41 - 2,0 - 0300**

type	_____
width	_____
height	_____
thickness	_____
length	_____

## Dimensions

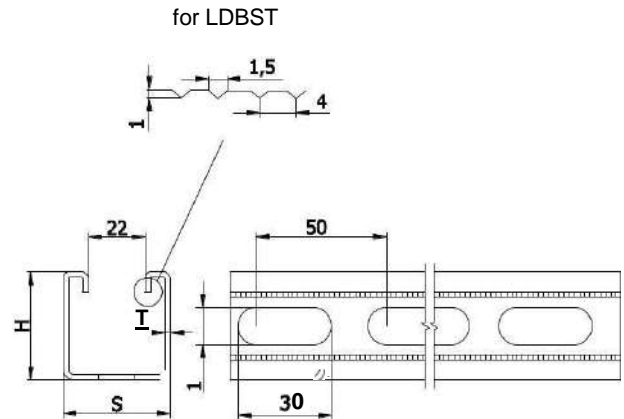

code	S [mm]	H [mm]	T [mm]	L [mb]
LDBST-41-21-2,0-0300	41	21	2,00	3,00
LDBST-41-21-2,0-0400	41	21	2,00	4,00
LDBST-41-21-2,0-0600	41	21	2,00	6,00
LDBST-41-21-2,5-0300	41	21	2,50	3,00
LDBST-41-21-2,5-0400	41	21	2,50	4,00
LDBST-41-21-2,5-0600	41	21	2,50	6,00
LDBST-41-41-2,0-0300	41	41	2,00	3,00
LDBST-41-41-2,0-0400	41	41	2,00	4,00
LDBST-41-41-2,0-0600	41	41	2,00	6,00
LDBST-41-41-2,5-0300	41	41	2,50	3,00
LDBST-41-41-2,5-0400	41	41	2,50	4,00
LDBST-41-41-2,5-0600	41	41	2,50	6,00

\* Standard length is 6 m

## STRUT channel LDBST

### Permissible load mounting profiles LDBST for different load patterns

Distance between supports $L$ [mm]	load patterns $F$ [N]			
	LDBST-41-21-2,0	LDBST-41-21-2,5	LDBST-41-41-2,0	LDBST-41-41-2,5
250	3251	3746	12167	14613
300	2709	3122	10139	12178
350	2322	2676	8691	10438
400	2032	2341	7605	9133
450	1714	2081	6760	8118
500	1388	1858	6084	7307
600	964	1290	5070	6050
700	708	948	3749	4445
800	542	726	2870	3403
900	428	573	2268	2689
1000	347	464	1837	2178
1200	241	322	1276	1513
1400	177	237	937	1111
1600	136	181	718	847
1800	107	143	567	672
2000	86	116	459	544
2250	68	92	362	430
2500	55	74	293	348
2750	46	61	242	288
3000			204	242
3250			173	206
3500			149	178
3750			130	155
4000			115	136
4250			101	121
4500			91	107
4750			81	96
5000			73	87
5250			67	79
5500			61	72
5750			55	65
6000			51	60

### Load diagram

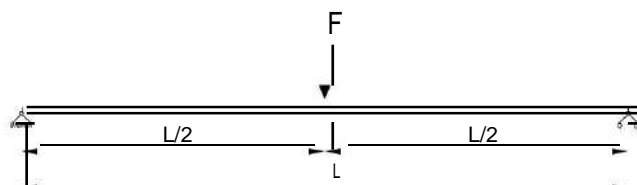

## STRUT channel LDBST

### Permissible load mounting profiles LDBST for different load patterns

Distance between supports $L$ [mm]	load patterns $F$ [N]			
	LDBST-41-21-2,0	LDBST-41-21-2,5	LDBST-41-41-2,0	LDBST-41-41-2,5
250	2438	2810	9125	10960
300	2032	2341	7605	9133
350	1675	2007	6518	7828
400	1282	1716	5703	6850
450	1013	1356	5070	6089
500	821	1098	4342	5148
600	570	763	3016	3575
700	419	560	2216	2627
800	321	429	1696	2011
900	253	339	1341	1589
1000	205	275	1086	1288
1200	143	191	754	894
1400	105	140	554	657
1600	80	107	424	503
1800	63	85	335	397
2000	51	69	271	322
2250		54	214	254
2500			174	206
2750			144	170
3000			121	143
3250			103	122
3500			89	105
3750			76	90
4000			68	80
4250			60	71
4500			54	64
4750			48	57
5000			43	51

### Load diagram

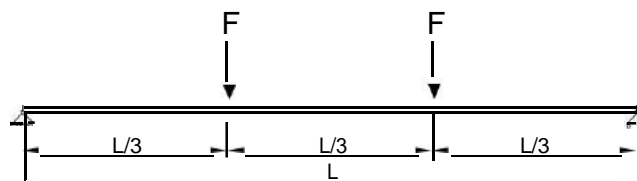

# STRUT channel

## LDBST

### Permissible load mounting profiles LDBST for different load patterns

Distance between supports <i>L [mm]</i>	load patterns <i>F [N]</i>			
	LDBST-41-21-2,0	LDBST-41-21-2,5	LDBST-41-41-2,0	LDBST-41-41-2,5
250	1625	1873	6084	7307
300	1355	1561	5070	6089
350	1161	1338	4345	5219
400	914	1171	3802	4567
450	722	966	3380	4059
500	585	782	3042	3653
600	406	543	2149	2548
700	298	399	1579	1872
800	228	306	1209	1433
900	181	242	955	1132
1000	146	196	774	917
1200	102	136	537	637
1400	75	100	395	468
1600	57	76	302	358
1800	45	60	239	283
2000		49	193	229
2250			153	181
2500			124	147
2750			102	121
3000			86	102
3250			73	87
3500			63	75
3750			55	65
4000			48	57
4250			43	51
4500				45

### Load diagram

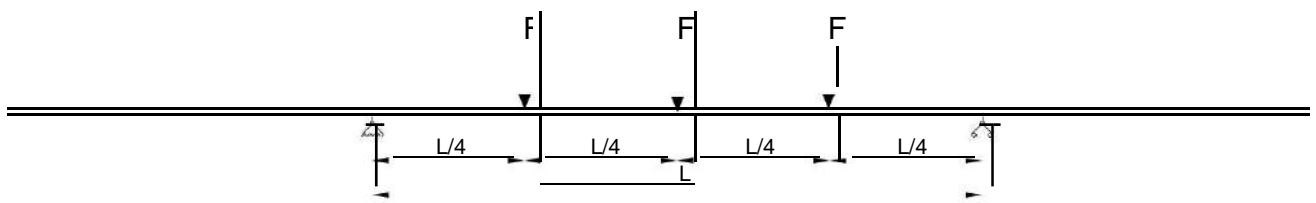

# STRUT channel

## LDBST

### Permissible load mounting profiles LDBST for different load patterns

Distance between supports <i>L [mm]</i>	load patterns <i>F [N]</i>			
	LDBST-41-21-2,0	LDBST-41-21-2,5	LDBST-41-41-2,0	LDBST-41-41-2,5
250	6502	7492	24335	29226
300	5418	6244	20279	24355
350	4534	5352	17382	20876
400	3472	4646	15209	18266
450	2743	3671	13519	16237
500	2222	2973	11758	13941
600	1543	2065	8166	9682
700	1134	1517	5999	7113
800	868	1161	4593	5446
900	686	918	3629	4303
1000	555	743	2940	3486
1200	386	516	2041	2421
1400	283	379	1500	1778
1600	217	290	1148	1361
1800	171	229	907	1076
2000	139	186	735	871
2250	110	147	581	688
2500	89	119	470	558
2750	73	98	389	461
3000	62	83	327	387
3250	53	70	278	330
3500	45	61	240	285
3750			209	248
4000			184	218
4250			163	193
4500			145	172
4750			130	154
5000			118	139
5250			107	126
5500			97	115
5750			89	105
6000			82	97

### Load diagram

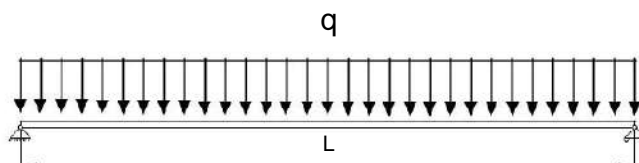

# Suspension Rings

CLR/CLRL



## Description

**CLR** - Suspension ring for round ducts. Consisting of two parts that are assembled with screws, with a quick release system on one side.

**CLRL** - Suspension ring with vibration-damping EPDM rubber.

### Example identification

Product code: **CLRL - aaa**

type  
ÆD

ÆD rated [mm]	weight [kg]	ÆD rated [mm]	weight [kg]
80	0,2	400	0,5
100	0,2	450	0,6
112	0,2	500	0,6
125	0,2	560	0,7
140	0,2	600	0,7
150	0,2	630	0,8
160	0,2	710	0,9
180	0,3	800	1,1
200	0,3	900	1,2
224	0,3	1000	1,3
250	0,3	1120	1,5
280	0,3	1250	1,6
300	0,4	1400	1,9
315	0,4	1500	2,0
355	0,5	1600	2,2

## Dimensions

For diameters  $d_1 \leq 400$  mm

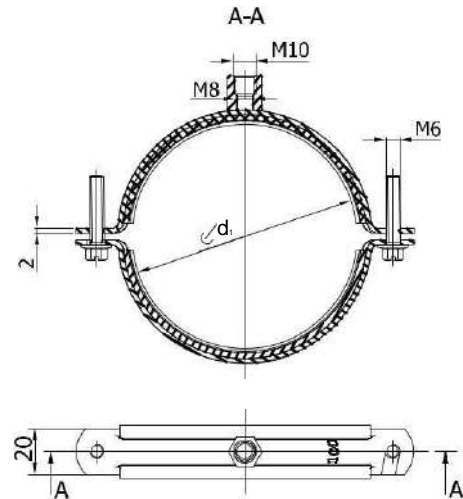

For diameters  $d_1 \geq 450$  mm

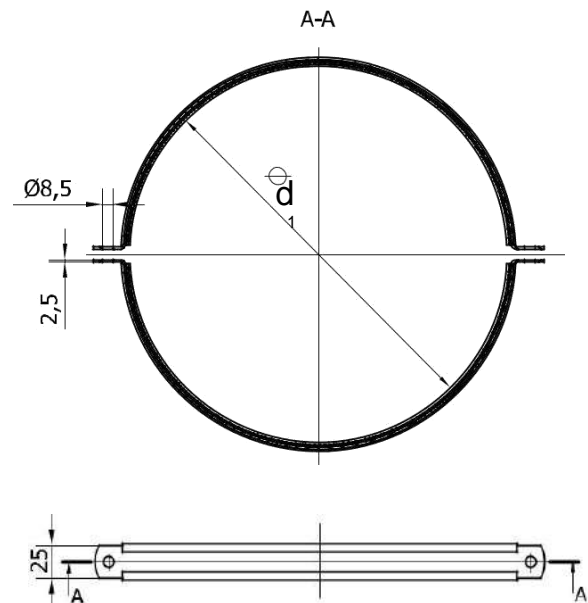

\* The rings with diameters from  $d_1 \geq 450$  mm on are supplied without combined nuts and are hung up two threaded rods

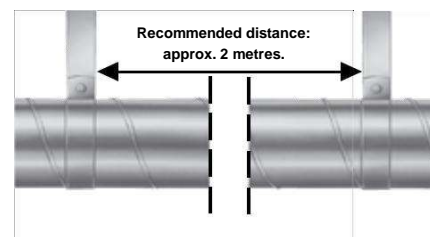

# Suspensions Rings for Heavy Duty CLRL-C

## Dimensions

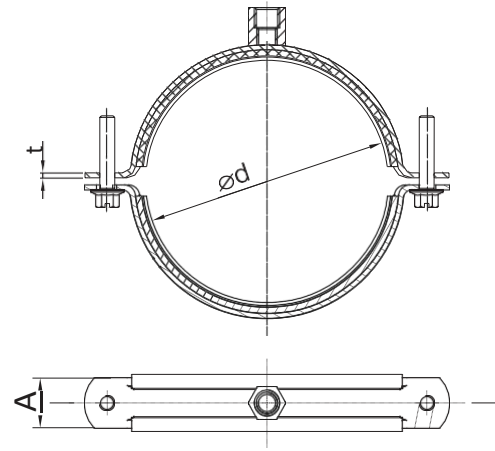

for  $16 \leq \varnothing d \leq 63$  rivetnut M8

for  $75 \leq \varnothing d \leq 168$  rivetnut M8, M10

for  $198 \leq \varnothing d \leq 252$  rivetnut M10

## Description

Suspension ring CLRL-C is used for round duct from 16 to 252 of diameters. At insulated duct it is recommended that the suspension ring is mounted inside the insulation.

### Example identification

Product code: **CLRL-C - 3/8**

type \_\_\_\_\_  
 $\varnothing d$  \_\_\_\_\_

code	$\varnothing d$ [cale]	Diameters range		A	t	Weight
		[mm]	[mm]	[mm]	[mm]	[kg]
CLRL-C-3/8	3/8"	16-20	20	1,5	0,052	
CLRL-C-1/2	1/2"	20-24	20	1,5	0,059	
CLRL-C-3/4	3/4"	25-30	20	1,5	0,069	
CLRL-C-1	1"	32-37	20	1,5	0,072	
CLRL-C-1 1/4	1 1/4"	40-45	20	1,5	0,087	
CLRL-C-1 1/2	1 1/2"	48-53	20	1,5	0,097	
CLRL-C-2	2"	59-63	20	1,5	0,104	
CLRL-C-2 1/2	2 1/2"	75-80	25	2,0	0,198	
CLRL-C-3	3"	85-92	25	2,0	0,226	
CLRL-C-3 1/2	3 1/2"	95-103	25	2,0	0,245	
CLRL-C-4	4"	108-116	25	2,0	0,252	
CLRL-C-5	5"	135-141	25	2,0	0,334	
CLRL-C-6	6"	169-168	25	2,0	0,4	
CLRL-C-200	-	198-202	30	3,0	0,723	
CLRL-C-8	8"	206-215	30	3,0	1,12	
CLRL-C-10	10"	248-252	30	3,0	1,275	

# G -Clamp KLQ



## Description

The KLQ clamp is used to protect rectangular duct connections with joining profile end cover.

### Example identification

Product code: **KLQ - 20**

type \_\_\_\_\_

## Dimensions

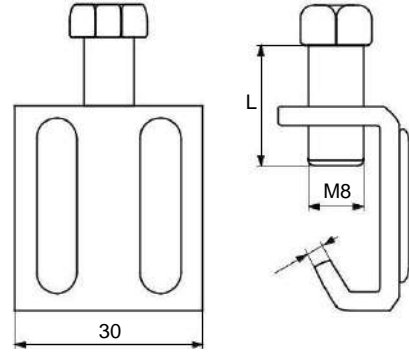

type	screw [mm]	L [mm]	G
KLQ-20	M8	25	3,0
KLQ-20-2,5	M8	20	2,5

## Connection method

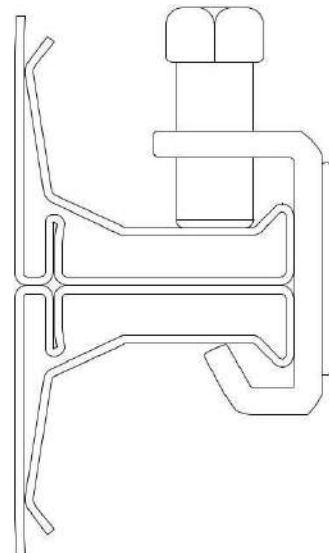

# Beam Clamp

## B-CLB



### Description

The TKN clamp is designed for the installation of threaded rods used for the suspension of electricity, heat, water and ventilation systems. The clamp is usually attached to steel beams of various shapes.

Note: Tighten the bolt by hand until it stops and then 1/2 turn the key. Then tighten the nut.

#### Example identification

Product code: **B-CLB - M8**

type \_\_\_\_\_

### Dimensions

B-CLB

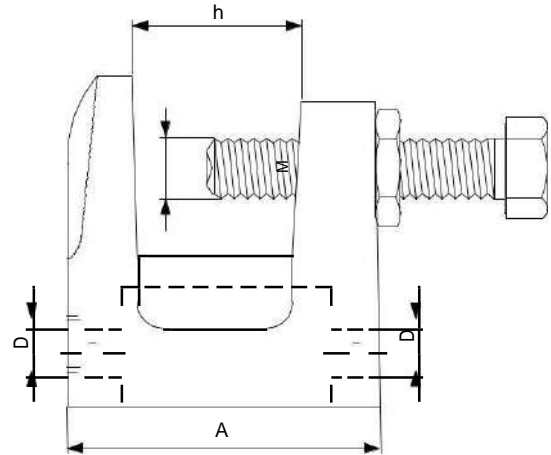

B-CLB-M

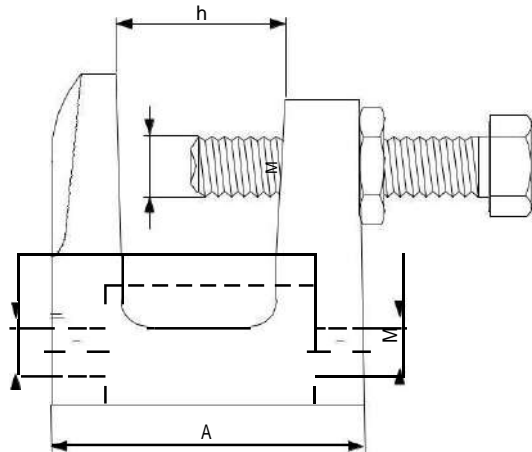

Typ	h [mm]	A [mm]	M [mm]	D [mm]
B-CLB-7	18	35	M6	7
B-CLB-9	18	35	M8	9
B-CLB-11	25	45	M10	11
B-CLB-13	25	45	M12	13
B-CLB-M6	16	30	M6	-
B-CLB-M8	18	35	M8	-
B-CLB-M10	23	45	M10	-
B-CLB-M12			M12	-

Type	Characteristic load $F_k$ [kN]	Recommended load $F_k$ [kN]	Average destructive load [kN]
M6	2,4	1,2	8,5
M8	4,0	2,0	19,5
M10	4,6	2,3	20,5

# Foot ST-P



## Description

The ST-P foot is used as a base to fasten the LDP profile.

### Example identification

Product code: **ST-P - 30**

type \_\_\_\_\_  
widtht \_\_\_\_\_

## Dimensions

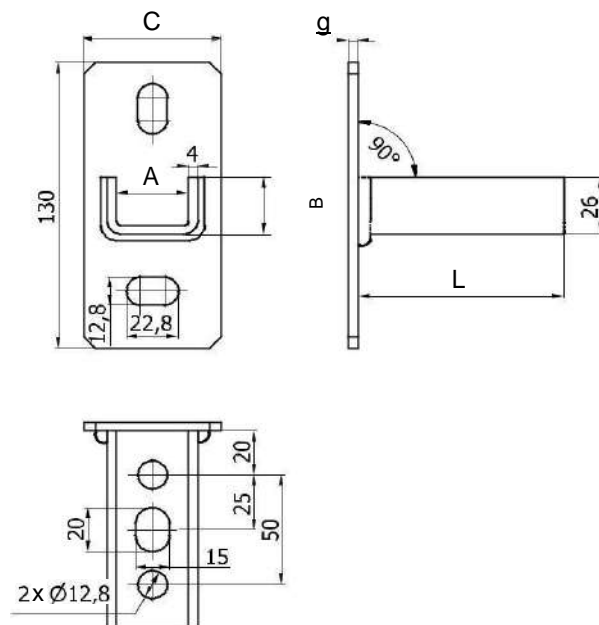

type	A [mm]	B [mm]	g [mm]	L [mm]	
ST-P-30	31	26	60	90	4
ST-P-40	41	26	70	90	4

# Duct Seal

USZ,USZ-CE



## Description

The USZ seal is made of self-adhesive polyethylene tape. Thermal resistance of the seal is up to 80°C. The USZ-CE ceramic seal has increased thermal resistance up to 1100°C. The USZ-CE seal is made of ceramic felt composed of aluminosilicate fibre. Glue material is based on modified acryl. The USZ and USZ-CE seals are applicable for sealing of connections in air conditioning and ventilation units. The USZ-CE seal is also applicable for sealing of systems with increased fire resistance.

### Parameters for USZ-CE:

Diameter of fibre	3,2 µm
Density	200-300 kg/m <sup>3</sup>
Tensile strength	> 350kPa lub 15,4 N/cm
Maximal working temperature	1100°C
Melting point	> 1300°C
Heat conduction	0,09 W/mK

### Example identification

Product code: **USZ - 10 - 4**

type \_\_\_\_\_  
width \_\_\_\_\_  
depth \_\_\_\_\_

## Dimensions

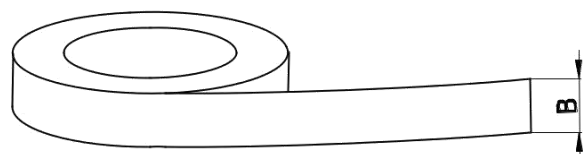

Code	S [mm]	depth [mm]	length [mb]
USZ-09-04	9	4	20
USZ-10-03	10	3	20
USZ-10-04	10	4	20
USZ-12-03	12	3	20
USZ-12-04	12	4	20
USZ-15-04	15	4	20
USZ-20-04	20	4	20

Code	S [mm]	depth [mm]	length [mb]
USZ-CE-10-04	10	4	20
USZ-CE-17-04	17	4	20

## Band clips for flexible ducts TKSE/TKSL

---

### Dimensions

#### TKS

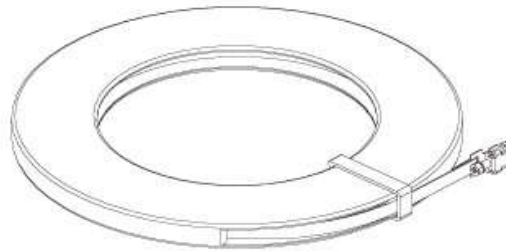

#### TKS

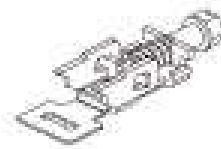

### Description

The TKSE band clip is necessary for connecting flexible ducts with shaped profiles, connectors, stub pipes etc. Properly shaped edges of the band clip prevent damages while its assembling and mounting. The TKSE band clip is available in 30 m length rolls. It has grooves on its whole length enabling its cutting for convenient pieces. Additionally the use of the TKSL clamps is necessary together with the TKSA band clip.

### Packing:

TKSE band - 30m/in roll  
TKSL band - 50psc/in box

### Example identification

Product code: **TKSE**

type \_\_\_\_\_

# Bends BP-90



## Description

BP – pressed bend, seam-welded and calibrated, without gasket..

$r_m \gg 1 \times d_1$

### Example identification

Product code: **BP - aaa - 90**

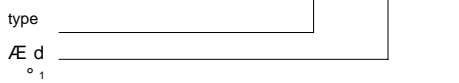

## Dimensions

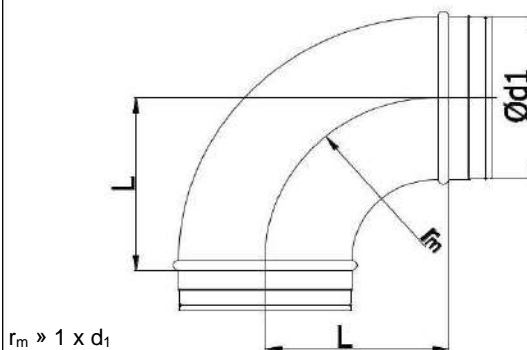

Æd <sub>1</sub> rated [mm]	L [mm]	weight [kg]
80	100	0,3
100	100	0,4
125	125	0,6
140	135	0,8
150	150	0,9
160	160	1,0
180	175	1,2
200	200	1,5
250	250	2,4

## Technical Data

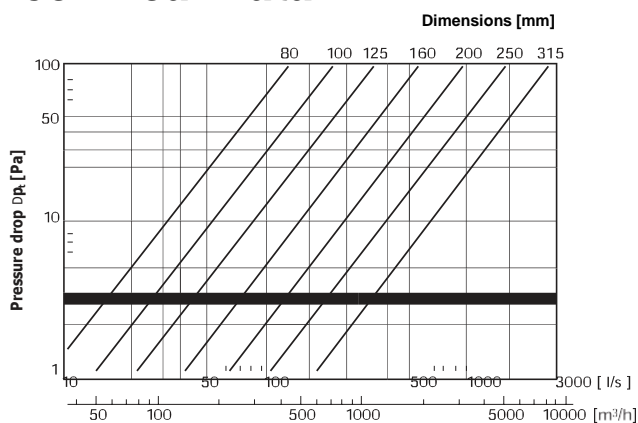

# Bends BP- 45



## Description

BP – pressed bend, seam-welded, without gasket, made of galvanized steel or stainless steel.

### Example identification

Product code: **BP - aaa - 45**

type \_\_\_\_\_  
 $\varnothing d$  \_\_\_\_\_  
 $\circ$  1 \_\_\_\_\_

## Technical Data

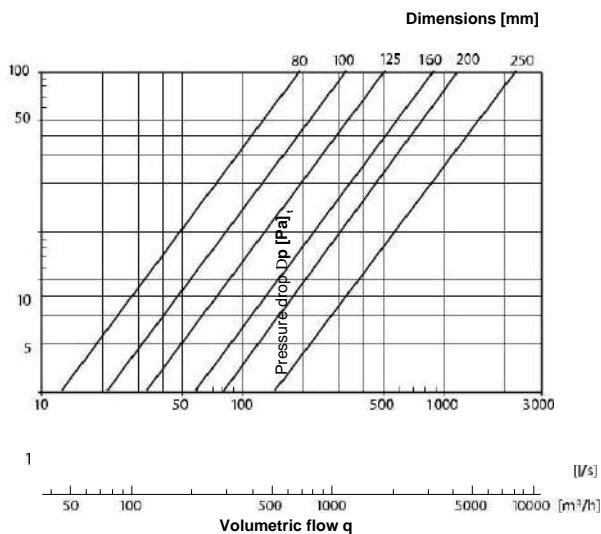

## Dimensions

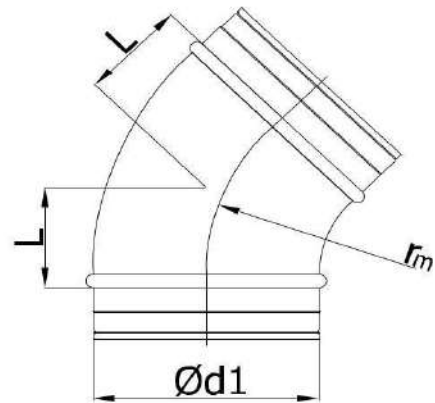

$$r_m \gg 1 \times d_1$$

Made of galvanized steel

$\varnothing d_1$ nom [mm]	L [mm]	weight [kg]
80	41	0,2
100	41	0,3
125	52	0,4
140	56	0,4
150	62	0,6
160	66	0,6
180	75	0,7
200	83	0,9
224	93	1,2
250	104	1,3
315	130	2,8

Made of stainless steel

$\varnothing d_1$ nom [mm]	A [mm]	L [mm]	weight [kg]
100	100	41	0,3
125	125	52	0,4
160	160	66	0,6
200	200	83	0,9

# Pressed male reducers RPC



## Dimensions

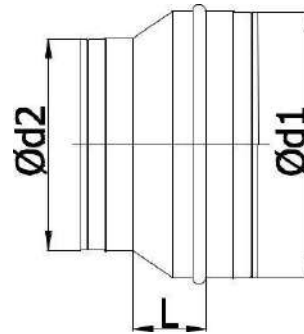

## Description

RPC – Pressed symmetric male-male reducer without gasket.

Ød<sub>1</sub> and Ød<sub>2</sub> – fits SPR ducts.

### Example identification

Product code: **RPC - aaa - bbb**

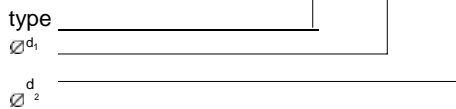

Ød <sub>1 rated</sub> [mm]	Ød <sub>2 rated</sub> [mm]	L [mm]	weight [kg]
100	80	18	0,20
125	80	28	0,20
	100	22	0,20
140	100*	30	0,20
	125	30	0,20
150	100	35	0,20
	125	30	0,20
	140	30	0,20
160	80	48	0,30
	100	37	0,30
	125	26	0,20
	140	30	0,30
	150	30	0,30
	160	30	0,30
180	125*	40	0,30
	140*	30	0,30
	150*	30	0,30
	160	30	0,30
200	100	58	0,40
	125	46	0,40
	140*	40	0,30
	150	35	0,30
	160	26	0,30
	180*	30	0,30
224	150*	50	0,40
	160*	50	0,40
	180*	30	0,40
	200	30	0,40

# ALUDUCT AD-L ALAD-L

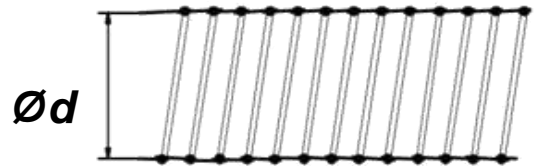

## Description

The ALUDUCT flexible duct is made of aluminium -polyester casing, reinforced with spirally wound steel wire.

**Packaging:** 10m sections, squeezed to 600mm, packed into cardboard boxes.

**Flexibility rate (winding diameter):** Relative to a specific diameter, i.e. approx. 0.6 x diameter in mm.

**Temperature range:** – 20°C to + 140°C

**Allowable negative pressure:** Depending on duct position. For straight sections, you can assume 1/3 of transmitted pressure per diameter.

Fire classification - E.g.-1364.3/A/06/MŽ

The product is also available in GREEN series characterized by low emissions of volatile organic compounds.

**Code:** ALAD-G-L **Name:** ALUDUCT-G AD-L

### Example identification

Product code: **ALAD-L - aaa**

type \_\_\_\_\_

Æd<sub>1</sub>

Æd <sub>1</sub> [mm]	Æd out [mm]	allowable pressure [Pa]	tolerance [mm]
80	82,0	2500	+ 1,5
100	102,0	2500	+ 1,5
125	127,0	2500	+ 1,5
140	140,0	2500	+ 1,5
150	152,0	2500	+ 1,5
160	160,0	2500	+ 2,0
180	180,0	2500	+ 2,0
200	203,0	2500	+ 2,0
225	229,0	2500	+ 2,0
250	254,0	2500	+ 3,0
280	280,0	2500	+ 3,0
300	305,0	2500	+ 3,0
315	315,0	2500	+ 3,0
355	355,0	2500	+ 3,0
400	406,0	2500	+ 4,0
450	457,0	2500	+ 4,0
500	508,0	2500	+ 4,0
560	568,0	2500	+ 4,0
630	638,0	2500	+ 4,0
710	718,0	2500	+ 4,0
800	810,0	2500	+ 4,0

# ALUDUCT

ALAD-L, ALAD-3

## Technical Data

Pressure drop chart for straight sections

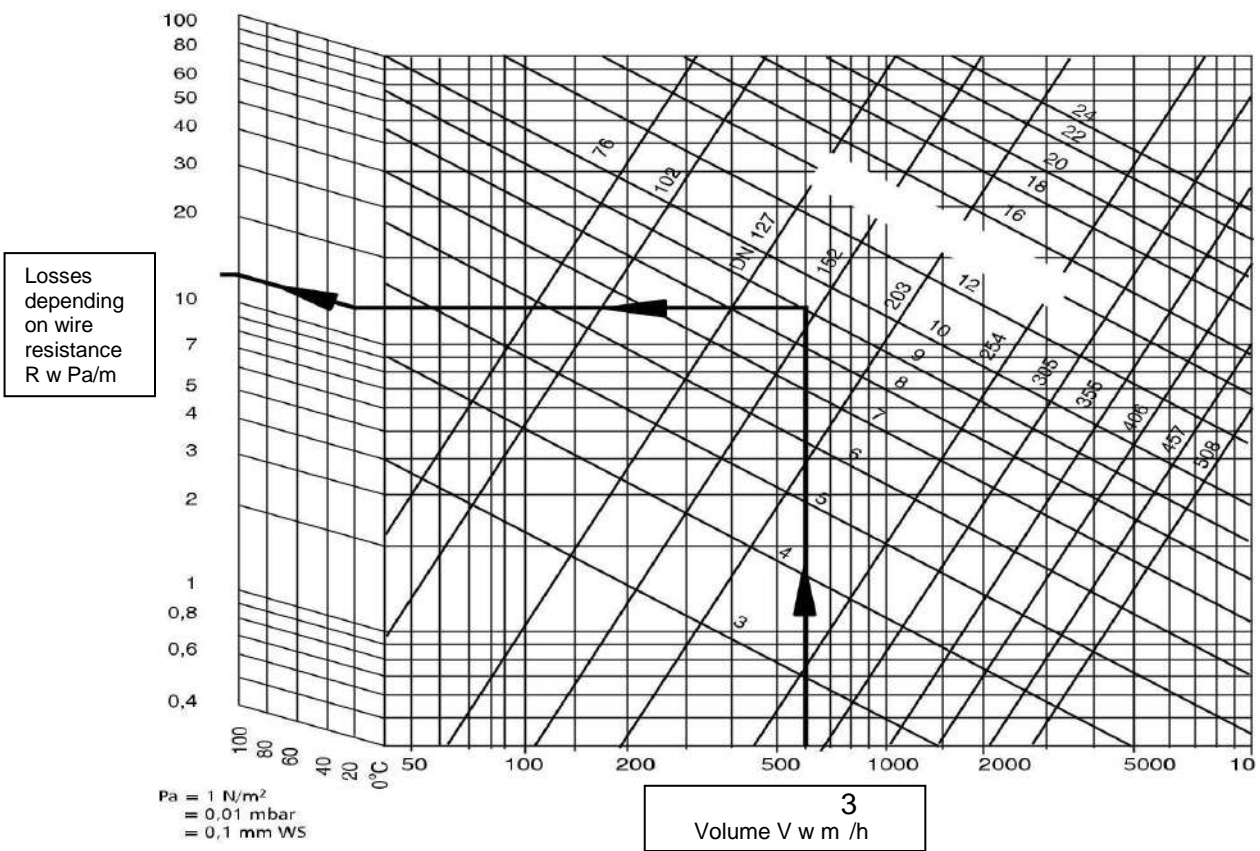

## SONOLIGHT AD-L ALSDL-L



### Dimensions

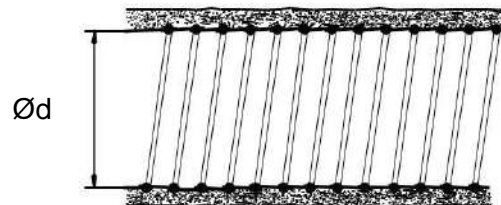

### Description

Flexible duct, noise and heat insulated, with additionally per-forated ALUDUCT AD- L insert. Insulated with a 25mm thick mineral wool, covered with aluminium-polyester film casing.

**Packaging:** 10m sections, squeezed to 1200mm, packed into cardboard boxes.

**Flexibility rate (winding diameter):** Relative to a specific external diameter, i.e. approx. 0.75 x diameter in mm.

**Temperature range:** – 30°C to + 120°C

Allowable negative pressure: Allowable negative pressure: Depending on duct position. For straight sections, you can assume 1/3 of transmitted pressure per diameter.

**Noise insulation:** See the attached diagram.

The duct is also available without perforation. **IZOLIGHT AD-L ALIDL-L**

Fire classification - E.g.-1258.1/A/07/MŽ

#### Example identification

Product code: **ALSDL-L - aaa**

type \_\_\_\_\_  
Æd<sub>1</sub>

Æd <sub>1</sub> rated [mm]	Æd ext [mm]	allowable pressure [Pa]	tolerance [mm]
80	82,0	2000	+ 1,5
100	102,0	2000	+ 1,5
125	127,0	2000	+ 1,5
140	140,0	2000	+ 1,5
150	152,0	2000	+ 1,5
160	160,0	2000	+ 2,0
180	180,0	2000	+ 2,0
200	203,0	2000	+ 2,0
225	229,0	2000	+ 2,0
250	254,0	2000	+ 3,0
280	280,0	2000	+ 3,0
300	305,0	2000	+ 3,0
315	315,0	2000	+ 3,0
355	355,0	2000	+ 3,0
400	406,0	2000	+ 3,0
450	457,0	2000	+ 3,0
500	508,0	2000	+ 3,0

## SONODUCT/SONOLIGHT

### Technical Data

#### Noise attenuation curves

The charts show noise levels for noise and heat insulated SONODUCT and SONOLIGHT ducts, depending on the section length: 500mm, 1000mm and 1500mm at a noise insulation thickness of approx. 25mm.

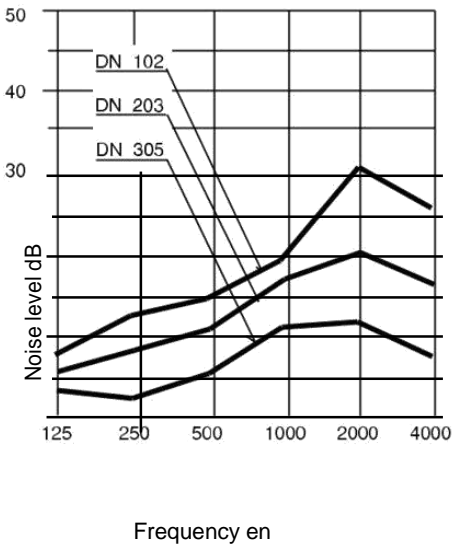

**Figure 1: noise level for SONODUCT/SONOLIGHT**  
 Noise insulation thickness 25 mm  
 Duct section length 500 mm

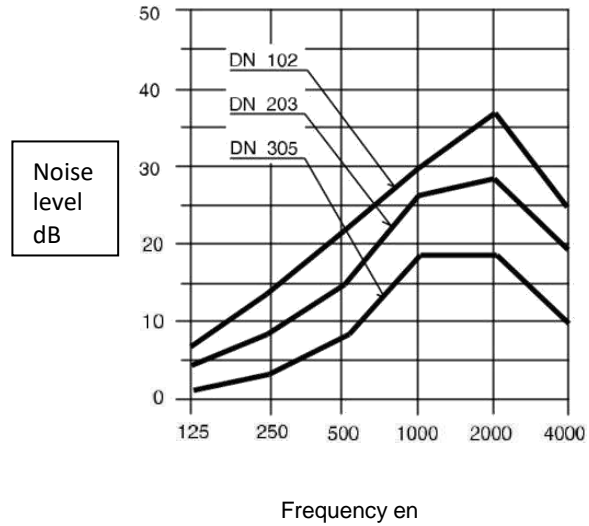

**Figure 2: noise level for SONODUCT/SONOLIGHT**  
 Noise insulation thickness 25 mm  
 Duct section length 1000 mm

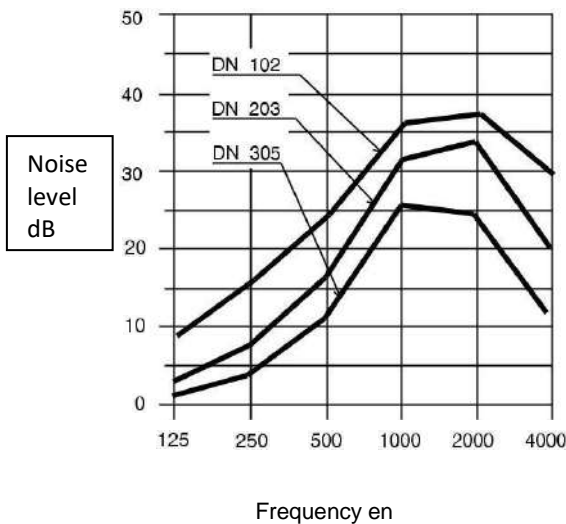

**Figure 3: noise level for SONODUCT/SONOLIGHT**  
 Noise insulation thickness 25 mm  
 Duct section length 1500 mm



Prefabricated Elements for multiblade dampers  
Self closing aluminum dampers

## **DSQOW-A-PREF**

---



### **Description**

Pre- fabricated elements for self closing DSQOW-A  
Multiblade damper allow to install them on your  
own, Tailoring them to the required dimensions.

### **Example identification**

Product code: **QDPS080**

Type: \_\_\_\_\_

## Rectangular flexible duct connector QILA



### Dimensions

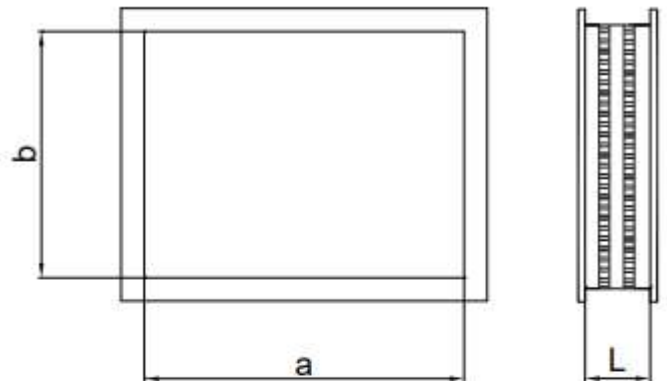

### Description

Flexible duct connector for rectangular ducts and elements. It is made of PQ flange channel and NQ corners interconnected by AMT flexible connection. Rectangular flexible duct connectors can be used to join ventilation ducts but above all it is used to eliminate vibrations caused by air handling units and fans. The design of the AMT flexible duct connector (a joint consisting of a layer of fabric and two strips of sheet metal on both sides) ensures very good airtightness.

#### Available materials

- QILA -..... - galvanized steel sheet, PVC coated fabric
- QILA- -HI-T-..... - galvanized steel sheet, silicone coated fabric
- QILA-PU-..... - galvanized steel sheet, polyurethane (PU) coated fabric
- QILA-K-PU-..... - stainless steel polyurethane (PU) coated fabric
- QILA-NEP-..... - galvanized steel sheet, neoprene coated fabric

#### Example identification

Product code: **QILA-PU - aaa - bbb - ccc**

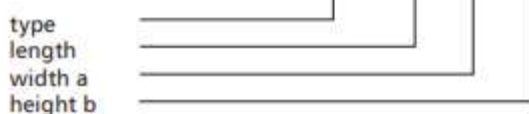

Max. width a: 2500 mm.  
Max. height b: 2500 mm

Standard lengths - L - of the flexible duct connector: 130, 150 or 240 mm  
(depending on the AMT flexible connection used for production)

### Technical Data

	Temperature range	Characteristics
PVC	-30 °C / +80 °C	General use, economical choice
Silicone (HI-T)	-30 °C / +260 °C	Resistance to high temperatures, high resistance to aging, weather conditions and chemical substances
Polyurethane (PU)	-30 °C / +180 °C	High abrasion resistance
Neoprene	-30 °C / +180 °C	Synthetic rubber, suitable for outdoor use, High resistance to alkalis and petrol.

AMT flexible connection used for flexible duct connectors' production was tested at 400 °C for 2 hours (PU and HI-T material). None of the tested flexible duct connectors suffered mechanical damage due to the heat treatment.

## Flexible duct connectors ILA



### Description

ILA male-end flexible duct connectors are used for joining two round SPIRAL or plain ducts. They are most often used for connecting air handling units, heat recuperation units, and duct fans. The flexible duct connector deadens the vibration generated by the equipment to prevent vibration and noise in the ductwork and ensure improved acoustic performance of the ventilation system. The flexible piece is made from AMT balancing tape, a standalone product available in different sizes and materials, including a heat-resistant version. The standard version is male.

The female-ended version is available on request for connecting two fittings.

#### Available materials - Product code example

ILA-... - galvanized steel sheet

ILA-KWS-... - 1.4301/304 stainless steel sheet

#### Product code example

Product code: ILA - aaa

type \_\_\_\_\_  
 $\varnothing d_1$  \_\_\_\_\_

### Dimensions

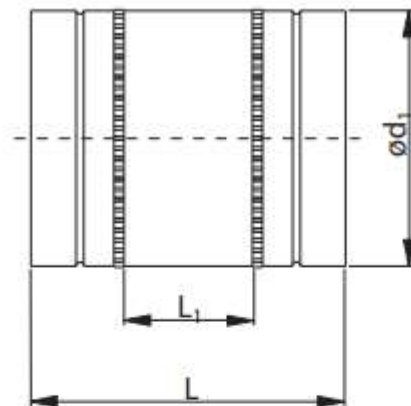

$\varnothing d_{1, \text{nom}}$ [mm]	L [mm]	L <sub>1</sub> [mm]
80	150	60
100	150	60
125	150	60
140	150	60
150	150	60
160	150	60
180	150	60
200	150	60
224	150	60
250	150	60
280	150	60
300	150	60
315	150	60
355	150	60
400	150	60
450	150	60
500	150	60
560	150	60
600	150	60
630	150	60
710	240	100
800	240	100

Length sizes available on request: 130, 165 mm.

## Steel Multi-Blade Damper DSQW



### DIMENSIONS

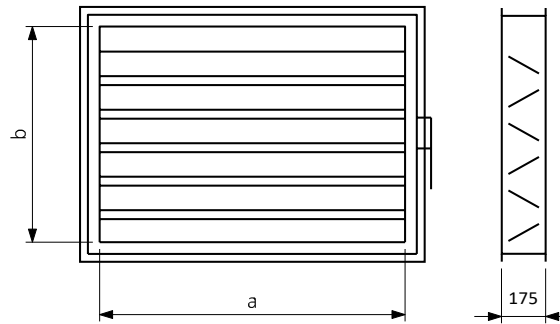

### Description

Multi-blade damper DSQW is used to control or close the air flow in ducts.

It can be installed both in system ventilation and in the heat recovery unit.

The damper comprises a housing consisting of four frame sections PQ Finished zinc and aluminum pens. The amount of feathers is the same for each dimension of the throttle. DSQW dampers can be controlled manually by a mechanism, an actuator on the outside of or prepared for mounting the actuator. The drive mechanism is located on the outside of the damper. Feathers rotating mechanism is composed of short axis, long series of gears mounted on bearings. The gears are on the outside valve.

If the dimension B is in the range 1000-2000, while the dimension A  $\geq$  1000 takes place using two mechanisms hand.

Dampers are divided executed when  $A \geq 1400$ .

Operating temperature range:  $-20^{\circ}\text{C}$  to  $+80^{\circ}\text{C}$ .

#### Example identification

Productcode: **DSQW 600 300**

Type \_\_\_\_\_  
 a \_\_\_\_\_  
 b \_\_\_\_\_

# Noise silencer

## SLQ

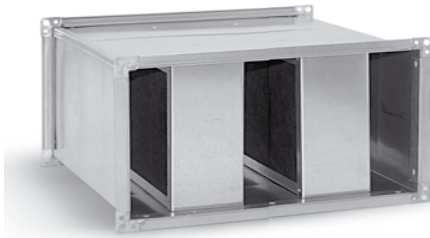

### Description

Rectangular duct silencers are intended for noise attenuation in ventilation and air-conditioning systems. Most often they are placed between a fan and a supply or exhaust air duct, and before air diffusers. The silencer is made of a housing with baffles inside. The housing is made of galvanised sheet metal, has mounting frames with sheet metal joining profiles on its ends, and is stiffened with transverse sheet corrugation. The baffles consist of a galvanised sheet metal frame and a sound-absorbing insert. The sound-absorbing insert is a combination of non-combustible mineral wool panels, and its external surface is covered with a special abrasion resistant fabric, which protects mineral wool.

ROCKWOOL panels covered with a black glass fibre veil, with coating that can support air flow rates of 2m/s, as well as industrial ROCKWOOL panels are used.

The maximum temperature of heat carrier is 250°C. The product is non-combustible.

For greater dimensions a or b, the baffles are supplied in combined form.

Depending on their design, there are two types of the baffles: A – absorptive baffles with all their surface covered with fabric. This type of baffles is used predominantly for low and medium frequencies.

B – absorptive/resonator baffles, which are similar to the absorptive baffles, but the sound-absorbing insert on both sides of the baffle is screened across half the baffle surface with galvanised sheet metal

These baffles are used mainly for medium and high frequencies. Distance s between the baffles is 40-100mm. Care should be taken when handling, storing and assembling silencers on site so as not to damage the surface of baffles. Rectangular silencers are placed in ventilation systems with vertical baffles. The allowable flow rate should be taken into account when selecting the type of silencer, depending on stream flow and the silencer's own noise.

### Dimensions

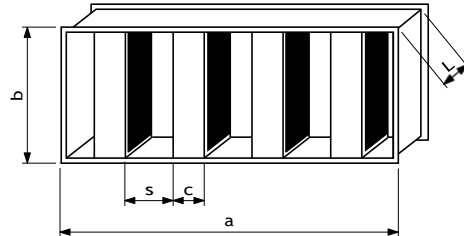

#### Baffle type A c = 100 or 200

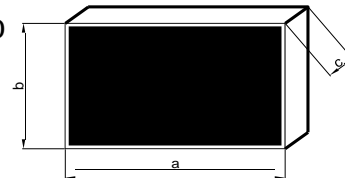

#### Baffle type B c = 100 or 200

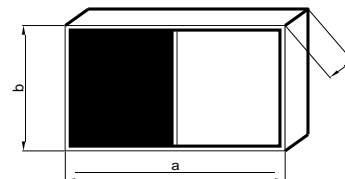

## Circular silencers SIL



### Description

The silencers are usually supplied with SPIRAL® system sealing. Diameters  $d_1 \geq 315$  mm require additional NSL couplings to be ordered, which should be installed in the silencer prior to installation. These male ends are not silencer parts, and they should be ordered separately. Glass mineral wool inside with thickness:

**50 mm dla SIL-50** - depending on the dimension of the outer casing

**100 mm dla SIL-100** - depending on the dimension of the outer casing

### Example identification

Product code: **SIL - iii - aaa - bbb**

type \_\_\_\_\_

insulation thickness

$d_1$  \_\_\_\_\_

L

## Aluminium Wall Air Intake Grill CSQ-A



### DIMENSIONS

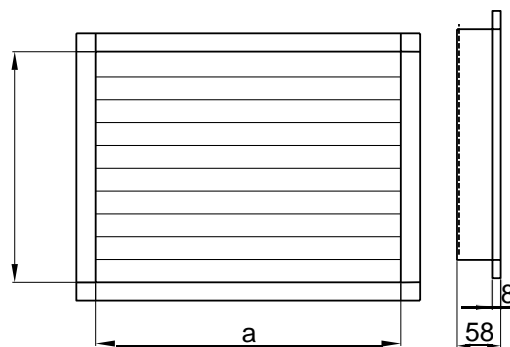

### Description

Wall air intake grilles are produced with fixed shutters protected with a 12,7 x 12,7 mm mesh made of 1 mm dia. galvanized wire. They are mounted on walls or as a termination of ventilation ducts.

They are made of aluminium. Optionally they can be powder painted.

The product has the hygienic certificate HK/B/1652/01/2007.

### Example identification

Product code: **CSQ-A - 2500 - 500**

Type

a

b

## The shut-off dampers

### DAS-PVC



### DIMENSIONS

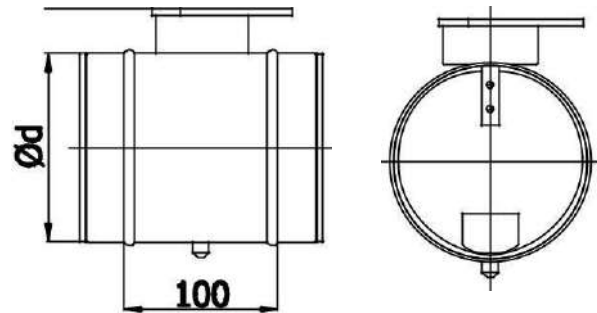

### Description

The DAS-PVC damper construction enables to use up to 30 mm insulation. The DAS-PVC closing damper can be used everywhere if a tight closing is not required. Position of the damper plane is visible on a handle within 0° to 90°.

The damper plane can be fixed by means of a bolt. Ends are made with a safe edge.

### Example identification

Product code: **DAS-PVC- aaa**

Type \_\_\_\_\_  
 $\varnothing d_1$  \_\_\_\_\_

$d_1$ nom [mm]	weight [kg]
80	0,40
100	0,46
125	0,55
140	0,60
150	0,65
160	0,70
180	0,75
200	0,80
224	0,90
250	1,10
280	1,30
300	1,45
315	1,50

## The shut-off dampers

### DASH



#### Description

The DASH closing damper can be used everywhere if a tight closing is not required. Position of the damper plane is visible on a handle within 0° to 90°. The damper plane can be fixed by means of a bolt with a wing-nut weight.

#### Example identification

Product code: **DASH - aaa**

type \_\_\_\_\_  
 $\text{\AA}d_1$  \_\_\_\_\_

#### DIMENSIONS

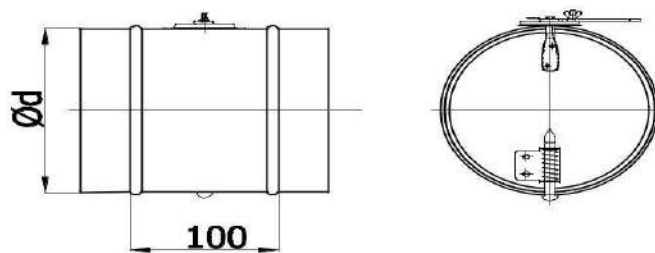

$\text{\AA}d_1$ nom [mm]	weight [kg]
80	0,4
100	0,4
125	0,5
140	0,6
150	0,6
160	0,7
180	0,7
200	0,8
224	0,9
250	1,2
280	1,4
300	1,5
315	1,6